

Projection

Screens



Wall Mounted Screens



Wall Mounted Screens

PROFESSIONAL white winder wall/ceiling projection screen



Easy to operate winder mechanism

- For wall or ceiling attachment (standard)
- Winder mechanism with detachable winder (attached on left-hand side of the screen)
- Matt-white 'M' screen fabric surface, with black backside
- Exact picture definitions: standard format with a 2.5 cm wide black border down both sides; 240 x 240 cm format comes with an attractive 5 cm black surround
- Screen housing in white (RAL 9016)
- Viewing angle approx. 50°
- Comes complete with fittings for wall/ceiling attachment

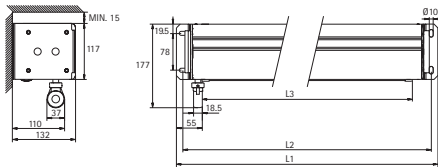

PROFESSIONAL white wall/ceiling projection screen



High quality roll up mechanism for quick and easy use

- For wall or ceiling attachment
- Spring roller projection screen
- Matt-white 'S' screen fabric surface, with black backside
- Exact picture definition: standard format comes with a 2.5 cm wide black border down both sides; 4:3 format comes with an attractive 5 cm black surround
- Contrast between black border and projected image increases visual clarity
- Viewing angle approx. 50°
- Screen housing in white (RAL 9016)
- For use in small to medium sized rooms
- Comes complete with fittings for wall/ceiling attachment

Accessories see page 89

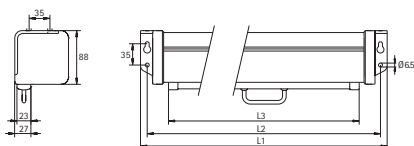

Technical information

Height x Width	ref. no.
160 x 160 cm	5430 52
180 x 180 cm	5430 53
200 x 200 cm	5430 54
240 x 240 cm	5430 56

case dimension height x width	L1 mm	L2 mm	L3 mm
160 x 160 cm	1727	1699	1620
180 x 180 cm	1927	1899	1820
200 x 200 cm	2147	2119	2040
240 x 240 cm	2547	2519	2440

- Weights:
 - 160 x 160 cm: 15 kg
 - 180 x 180 cm: 16 kg
 - 200 x 200 cm: 20 kg
 - 240 x 240 cm: 26 kg
- Viewing size:
 - 160 x 160 cm: 151 x 151 cm
 - 180 x 180 cm: 173 x 173 cm
 - 200 x 200 cm: 195 x 195 cm
 - 240 x 240 cm: 230 x 230 cm
- Gain: 1.0

Technical information

Standard format

Height x Width	ref. no.
160 x 160 cm	5402 52
180 x 180 cm	5402 53
200 x 200 cm	5401 54
240 x 240 cm	5401 56

case dimension height x width	L1 mm	L2 mm	L3 mm
160 x 160 cm	1711	1689	1620
180 x 180 cm	1911	1889	1820
200 x 200 cm	2131	2109	2109
240 x 240 cm	2531	2509	2440

- Weights:
 - 160 x 160 cm: 10 kg
 - 180 x 180 cm: 12 kg
 - 200 x 200 cm: 14 kg
 - 240 x 240 cm: 17 kg
- Viewing size:
 - 151 x 151 cm
 - 173 x 173 cm
 - 195 x 195 cm
 - 235 x 235 cm

4:3 format for data/video projection

Height x Width	ref. no.
123 x 160 cm	5403 52
138 x 180 cm	5403 53
153 x 200 cm	5403 54
183 x 240 cm	5403 56

case dimension height x width	L1 mm	L2 mm	L3 mm
123 x 160 cm	1711	1689	1620
138 x 180 cm	1911	1889	1820
153 x 200 cm	2131	2109	2040
183 x 240 cm	2531	2509	2440

- Weights:
 - 123 x 160 cm: 9 kg
 - 138 x 180 cm: 11 kg
 - 153 x 200 cm: 13 kg
 - 183 x 240 cm: 16 kg
- Viewing size:
 - 109 x 146 cm
 - 126 x 168 cm
 - 143 x 190 cm
 - 173 x 230 cm
- Gain: 1.0

UNIVERSAL white wall/ceiling projection screen

Technical information



Roll up mechanism for quick and easy use

- For wall or ceiling attachment
- Spring roller projection screen
- Matt-white 'S' screen fabric surface, with black backside
- Exact picture definition: comes with a 2.5 cm wide black border down both sides
- Contrast between black border and projected image increases visual clarity
- Viewing angle approx. 50°
- Screen housing in white (RAL 9016)
- For use in small rooms
- Comes complete with fittings for wall/ceiling attachment

Accessories see page 89

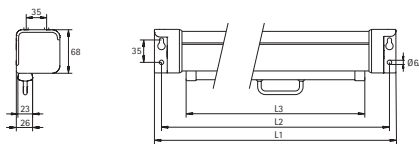

Pull-down bar



Wall hooks
57 cm



Ceiling attachments for
wall/ceiling screens

Standard format

Height x Width	ref. no.
125 x 125 cm	5401 50
160 x 160 cm	5401 52
180 x 180 cm	5401 53

case dimension height x width	L1 mm	L2 mm	L3 mm
125 x 125 cm	1380	1358	1282
160 x 160 cm	1718	1696	1620
180 x 180 cm	1918	1896	1820

- Weights:
 - 125 x 125 cm: 5 kg
 - 160 x 160 cm: 7 kg
 - 180 x 180 cm: 8 kg
- Viewing size:
 - 120 x 120 cm
 - 151 x 151 cm
 - 173 x 173 cm

16:9 format for wide screen use

Height x Width	ref. no.
90 x 160 cm	5400 25
102 x 180 cm	5400 27
117 x 200 cm	5400 29

case dimension height x width	L1 mm	L2 mm	L3 mm
90 x 160 cm	1718	1696	1620
102 x 180 cm	1918	1896	1820
117 x 200 cm	2138	2116	2040

- Weights:
 - 90 x 160 cm: 6 kg
 - 102 x 180 cm: 7 kg
 - 117 x 200 cm: 8 kg
- Viewing size:
 - 82 x 146 cm
 - 95 x 168 cm
 - 107 x 190 cm

4:3 format for data/video projection

Height x Width	ref. no.
123 x 160 cm	5400 52
138 x 180 cm	5400 53
153 x 200 cm	5400 54

case dimension height x width	L1 mm	L2 mm	L3 mm
123 x 160 cm	1718	1696	1620
138 x 180 cm	1918	1896	1820
153 x 200 cm	2138	2116	2040

- Weights:
 - 123 x 160 cm: 6 kg
 - 138 x 180 cm: 7 kg
 - 153 x 200 cm: 8 kg
- Viewing size:
 - 110 x 146 cm
 - 126 x 168 cm
 - 143 x 190 cm
- Gain: 1.0

Accessories

	ref. no.
Pull-down bar	5450 00
Wall hooks 57 cm	5452 00
Ceiling attachment	see page 89

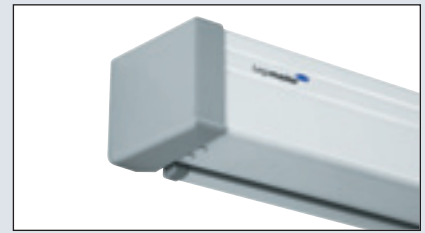

Electric motor for professional control

- For wall or ceiling attachment (standard)
- Optional: ceiling attachment for securing to suspended ceilings (max. 100 cm long)
- Electrically operated projection screen (motor on the left-hand side of the screen); plus 3 m cable and separate switch
- Matt-white 'M' screen fabric surface, with black backside
- Automatic stop for rolling up and down guarantees long lifespan of projection screen fabric
- Exact picture definition: standard format comes with a 2.5 cm wide black border down both sides; formats of 240 x 240 and greater have a 5 cm border; 4:3 format comes complete with a 5 cm black surround
- Viewing angle approx. 50°
- Screen housing in white (RAL 9016)
- Comes complete with fittings for attachment and wall spacers in accordance with German standards (VDE)

Accessories see page 89

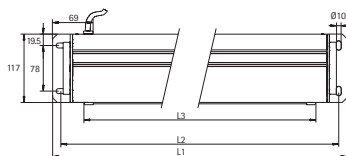
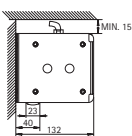

Standard format

Height x Width	ref. no.
160 x 160 cm	5501 52
180 x 180 cm	5501 53
200 x 200 cm	5501 54
240 x 240 cm	5501 56
300 x 300 cm	5501 59

case dimension height x width	L1 mm	L2 mm	L3 mm
160 x 160 cm	1727	1699	1620
180 x 180 cm	1927	1899	1820
200 x 200 cm	2147	2119	2040
240 x 240 cm	2547	2519	2440
300 x 300 cm	3147	3119	3040

- Weights:
 - 160 x 160 cm: 16 kg
 - 180 x 180 cm: 17 kg
 - 200 x 200 cm: 21 kg
 - 240 x 240 cm: 27 kg
 - 300 x 300 cm: 35 kg
- Viewing size:
 - 160 x 160 cm: 151 x 151 cm
 - 180 x 180 cm: 173 x 173 cm
 - 200 x 200 cm: 195 x 195 cm
 - 240 x 240 cm: 230 x 230 cm
 - 300 x 300 cm: 290 x 290 cm

4:3 format for data/video projection

Height x Width	ref. no.
138 x 180 cm	5515 53
153 x 200 cm	5515 54
183 x 240 cm	5515 56
228 x 300 cm	5515 59
300 x 400 cm	5515 63

case dimension height x width	L1 mm	L2 mm	L3 mm
138 x 180 cm	1927	1899	1820
153 x 200 cm	2147	2119	2040
183 x 240 cm	2547	2519	2440
228 x 300 cm	3147	3119	3040
300 x 400 cm	4174	4144	4080

- Weights:
 - 138 x 180 cm: 17 kg
 - 153 x 200 cm: 19 kg
 - 183 x 240 cm: 24 kg
 - 228 x 300 cm: 31 kg
 - 300 x 400 cm: 78 kg
- Viewing size:
 - 138 x 180 cm: 126 x 168 cm
 - 153 x 200 cm: 143 x 190 cm
 - 183 x 240 cm: 173 x 230 cm
 - 228 x 300 cm: 218 x 290 cm
 - 300 x 400 cm: 290 x 390 cm
- Gain: 1.0



Especially for small rooms

- Electrical projection screen
- Easy to assemble: for wall and ceiling attachment
- Silent motor with 5 year guarantee; VDE tested
- Matt-white 'S' screen fabric surface, with black backside
- Contrast between black border and projected image increases visual clarity
- Automatic stop for rolling up and down guarantees long lifespan of projection screen fabric
- Exact picture definition: standard format comes with a 2.5 cm wide black border down left and right side; 4:3 format comes with an attractive 5 cm black surround
- Available in a selection of standard formats
- Viewing angle approx. 50°
- Screen housing in white (RAL 9016)
- Comes complete with 3 metre connection cable and switch

Accessories see page 89

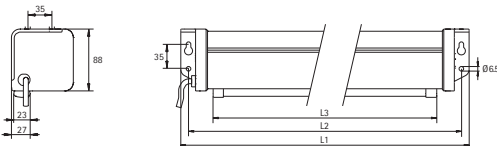

Standard format

Height x Width	ref. no.
160 x 160 cm	5530 52
180 x 180 cm	5530 53
200 x 200 cm	5530 54
240 x 240 cm	5530 56

case dimension height x width	L1 mm	L2 mm	L3 mm
160 x 160 cm	1711	1689	1620
180 x 180 cm	1911	1889	1820
200 x 200 cm	2131	2109	2040
240 x 240 cm	2531	2509	2440

- Weights:
 - 160 x 160 cm: 10 kg
 - 180 x 180 cm: 12 kg
 - 200 x 200 cm: 14 kg
 - 240 x 240 cm: 18 kg
- Viewing size:
 - 160 x 160 cm: 151 x 151 cm
 - 180 x 180 cm: 173 x 173 cm
 - 200 x 200 cm: 195 x 195 cm
 - 240 x 240 cm: 230 x 230 cm

4:3 format

Height x Width	ref. no.
138 x 180 cm	5531 53
153 x 200 cm	5531 54
183 x 240 cm	5531 56

case dimension height x width	L1 mm	L2 mm	L3 mm
138 x 180 cm	1911	1889	1820
153 x 200 cm	2131	2109	2040
183 x 240 cm	2531	2509	2440

- Weights:
 - 138 x 180 cm: 12 kg
 - 153 x 200 cm: 14 kg
 - 183 x 240 cm: 18 kg
- Viewing size:
 - 138 x 180 cm: 126 x 168 cm
 - 153 x 200 cm: 143 x 190 cm
 - 183 x 240 cm: 173 x 230 cm
- Gain: 1.0

ECONOMY white wall/ceiling projection screen

Technical information



Standard format

Height x Width	ref. no.
160 x 160 cm	5566 52
180 x 180 cm	5566 53
200 x 200 cm	5566 54

case dimension height x width	L1 mm	L2 mm	L3 mm
160 x 160 cm	1718	1696	1620
180 x 180 cm	1918	1896	1820
200 x 200 cm	2138	2116	2040

- Weights:
 - 160 x 160 cm: 8 kg
 - 180 x 180 cm: 9 kg
 - 200 x 200 cm: 10 kg
- Viewing size:
 - 160 x 160 cm: 151 x 151 cm
 - 180 x 180 cm: 173 x 173 cm
 - 200 x 200 cm: 195 x 195 cm

4:3 format

Height x Width	ref. no.
123 x 160 cm	5564 52
138 x 180 cm	5564 53
153 x 200 cm	5564 54

case dimension height x width	L1 mm	L2 mm	L3 mm
123 x 160 cm	1718	1696	1620
138 x 180 cm	1918	1896	1820
153 x 200 cm	2138	2116	2040

- Weights:
 - 123 x 160 cm: 7 kg
 - 138 x 180 cm: 8 kg
 - 153 x 200 cm: 9 kg
- Viewing size:
 - 123 x 160 cm: 110 x 146 cm
 - 138 x 180 cm: 126 x 168 cm
 - 153 x 200 cm: 143 x 190 cm
- Gain: 1.0

Accessories

	ref. no.
Ceiling fittings	5545 00
Wall hooks 57 cm	5452 00
High-frequency remote control	5555 00
Infrared remote control	5540 00

Ultimate electrical compact screen

- Compact model, electrical projection screen
- Easy to assemble: for wall or ceiling attachment
- Contrast between black border and projected image increases visual clarity
- Matt-white 'S' screen fabric surface
- Automatic stop for rolling up and down guarantees long lifespan of projection screen fabric
- Viewing angle approx. 50°
- Screen housing in black (RAL 7021)
- Comes complete with 3 metre connection cable and switch

Accessories see page 89



Ceiling fittings
Max. 100 cm



Wall hooks
57 cm



High-frequency or infrared
remote control

■ Accessories for projection screens

● Technical information



Set of wall hooks

- Special wall assembly
- Recommended for preventing distortion during projection in daylight conditions

57 cm - For UNIVERSAL white / ECONOMY white
ref. 5452 00

75 cm - For PROFESSIONAL white / PROFESSIONAL white winder / PROFESSIONAL white electrical
ref. 5551 00



Ceiling attachment

- For wall screens:
PROFESSIONAL white winder
- For electrical screens:
PROFESSIONAL white

ref. 5552 00 Max. 100 cm

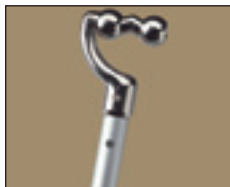

Pull-down bar

- Practical way of pulling down the screen; with spring loaded mechanism

ref. 5450 00



Ceiling attachment

- For wall screens:
PROFESSIONAL white, UNIVERSAL white
- For electrical screens:
UNIVERSAL white / ECONOMY white

ref. 5545 00

- For all wall/ceiling projection screens
- Brackets (100 cm) can be shortened as required

- Brackets (100 cm) can be shortened as required

- Pull-down bar suitable for all manually operated wall / ceiling projection screens
- Length: 125 cm

- Brackets (100 cm) can be shortened as required

■ Remote controls

● Technical information

Remote controls

To operate the projection screen from a distance, a remote control is a practical and simple solution. The remote control comprises a control module, a remote switch and a handheld transmitter. The remote control can be installed without any extra wiring and also is perfectly suitable for pre-existing projection screens.



After quick and easy programming, the high-frequency remote control switch and handheld transmitter can be used within a range of 30 metres of the screen.

Cordless high-frequency remote control
ref. 5555 00

After quick and easy programming, the infrared remote control switch and handheld transmitter can be used within a range of 7 metres of the screen.

Cordless infrared remote control
ref. 5540 00

TCO

www.tco.uk.com

Making Offices Work

Products

Office Furniture

Meeting Tables

Receptions

Office Extras

Seating

Interiors / Blinds

Educational

Storage Solutions

Customer Services

Office Design

Furniture Repairs

Office Relocations

Interior Design

Total Concept Office Limited
Concept House Castle Street
Melbourne Derbyshire
DE73 8JA

Telephone 01332 864806
Facsimile 01332 865397
Email sales@tco.uk.com

Company Reg Number: 3560818